

## Self-Collection Instructions for Vaginal Swabs

The following collection instructions are intended to help you collect a vaginal sample for the test your clinician has requested. First read the instructions carefully, and then follow each step to ensure accurate results.

1. Using the moist towelette provided, wipe away excessive amounts of secretion around the vagina.

Partially peel open the plastic film layers of the swab package.

2. Remove cap from transport tube. Do not touch the soft tip or lay the swab down.

**If the soft tip is touched, laid down, or dropped, use a new swab.**

3. Remove swab and collect specimen.

4. While in a comfortable position, (seated or standing), without touching the outer folds of the vagina, carefully insert the swab into your vagina about **2 inches (5 cm)** inside the opening of the vagina and gently rotate the swab for **10 to 30 seconds**.

5. Make sure the swab touches the walls of the vagina so that moisture is absorbed by the swab and then withdraw the swab without touching the skin.

6. Immediately insert swab in tube and close cap (always replace cap firmly to complete seal).

7. Label swab with full name, date of birth or health card number, source of specimen and date and time of collection.

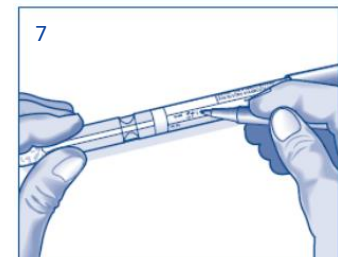
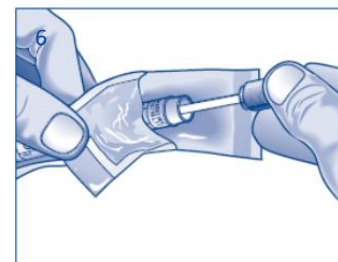
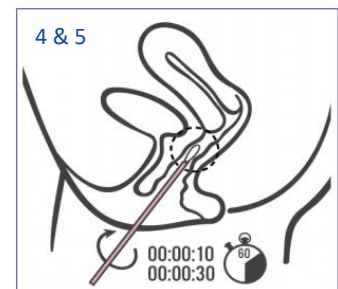
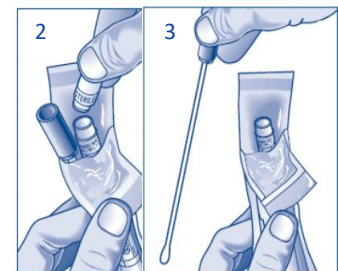
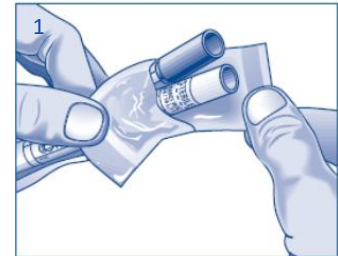

### References:

Copan USA. (2011, June). *CopanTransystem Product Insert*. ([https://www.copanusa.com/wp-content/uploads/2019/11/Transystem-Package-Insert\\_PI-Transystem-H219DD-Rev04.pdf](https://www.copanusa.com/wp-content/uploads/2019/11/Transystem-Package-Insert_PI-Transystem-H219DD-Rev04.pdf))  
 Hologic (2017, May). *Instructions for Using the Aptima™ Multitest Swab Specimen Collection Kit for Patient-Collected Specimens*.  
[https://www.hologic.com/sites/default/files/2018-06/AW-14334-001\\_003\\_01.pdf](https://www.hologic.com/sites/default/files/2018-06/AW-14334-001_003_01.pdf)